

HISTORIC NORCROSS DENTAL

51 S Peachtree Street, Norcross, GA 30071



- 1,108 SF former dental office for lease.
- The unit is located in the heart of the historic Downtown Norcross district.
- Neighboring tenant retails jewelry, gifts, and clothes.
- Successful local offices, restaurants, and retailers surround the property.
- Located close to the busy intersection of Holcomb Bridge Rd (13,400 VPD) and Buford Hwy E (40,600 VPD).
- Benefits from a mix of lively city events, including festivals, concerts, and markets.

Information contained in this marketing brochure has been obtained by the owner of the property or other sources that we deem reliable, however, we cannot guarantee the accuracy of it. You should conduct an independent investigation of the shopping center to verify all information in determining the suitability of the property.



Demographics

	1 Mile	3 Miles	5 Miles
Est. Population	11,103	87,359	261,650
# of Households	3,901	32,989	96,918
Avg. Household Income (\$)	\$131,012	\$95,702	\$107,700
Est. Daytime Pop.	7,740	65,022	120,162

	5 Min	10 Min	15 Min
Drivetime Population	12,715	78,341	280,522

Site Plan

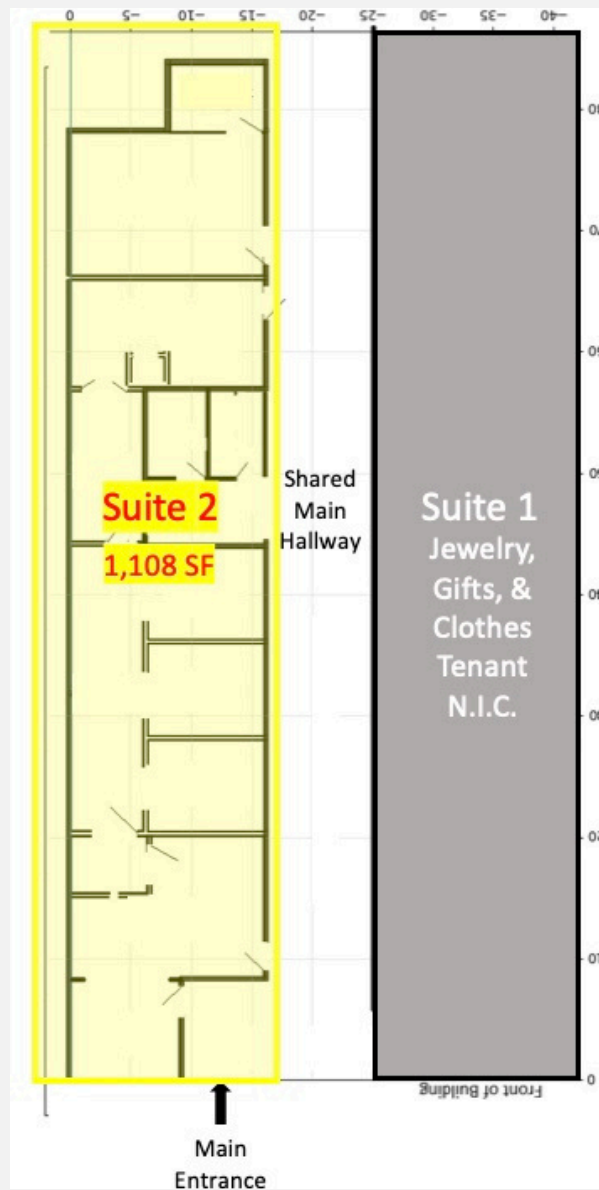

Suite	Tenant	Size/SF	Suite	Tenant	Size/SF
1	Anna Balkan Jewelr...	-	2	Available	1,108 SF

Contacts

Kimberly Dart Heidt

770-356-1976

Kim@DartRetail.com

Paul Hanna

770-698-9339

Paul.Hanna@JLL.com